

Connecting Rod

Part Number	Length	Material	Finish
-------------	--------	----------	--------

747-43.3 43.31 [1100.0] steel zinc plated

- ▶ custom lengths can be made to your specifications
- ▶ used with die cast zinc rod adapter (sold separately, part no. **C20**)

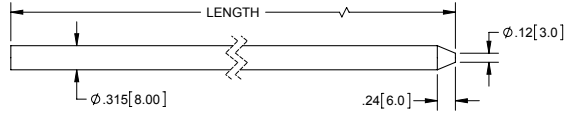

Connecting Rods with Plastic Wheels

Part Number	Length	Material	Finish
-------------	--------	----------	--------

743-27 27.00 [685.8] steel zinc plated

743-43.3 43.30 [1100.0] steel zinc plated

743-47.25 47.25 [1200.2] steel zinc plated

- ▶ custom lengths can be made to your specifications
- ▶ used with die cast zinc rod adapter (sold separately, part no. **C20**)

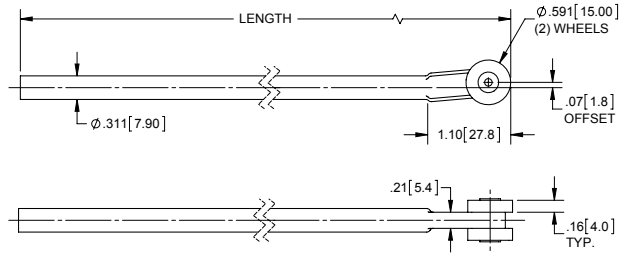

Connecting Rods with Plastic Wheels Perpendicular to Flat End

Part Number	Length	Material	Finish
-------------	--------	----------	--------

744-15.8 15.75 [400.0] steel zinc plated

744-19.7 19.69 [500.0] steel zinc plated

744-23.6 23.62 [600.0] steel zinc plated

744-27.6 27.56 [700.0] steel zinc plated

744-31.5 31.50 [800.0] steel zinc plated

744-35.4 35.43 [900.0] steel zinc plated

744-39.4 39.37 [1000.0] steel zinc plated

744-43.3 43.30 [1100.0] steel zinc plated

- ▶ custom lengths can be made to your specifications

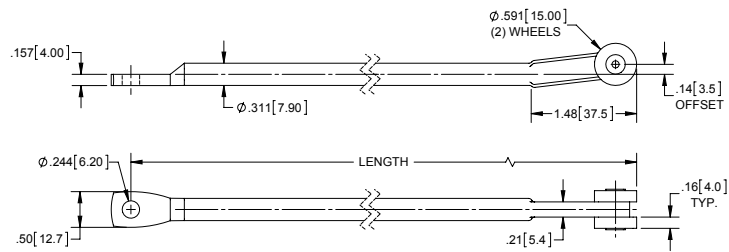

Connecting Rods with Plastic Wheels In-line with Flat End

Part Number	Length	Material	Finish
-------------	--------	----------	--------

744A-15.8 15.75 [400.0] steel zinc plated

744A-19.7 19.69 [500.0] steel zinc plated

744A-23.6 23.62 [600.0] steel zinc plated

744A-27.6 27.56 [700.0] steel zinc plated

744A-31.5 31.50 [800.0] steel zinc plated

744A-35.4 35.43 [900.0] steel zinc plated

744A-39.4 39.37 [1000.0] steel zinc plated

744A-43.3 43.30 [1100.0] steel zinc plated

- ▶ custom lengths can be made to your specifications

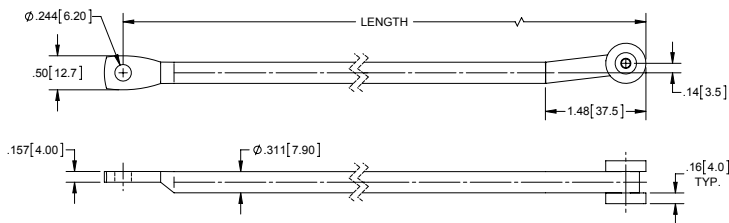

Rod Guides

Part Number	Material	Finish	A	B	C	D
-------------	----------	--------	---	---	---	---

702-05 plastic black, smooth 1.50 [38.1] .86 [21.8] .96 [24.4] .19 [4.8]

702-06 plastic black, smooth 1.25 [31.8] .60 [15.2] .73 [18.5] .14 [3.56]

- ▶ material: black plastic with steel, zinc plated threaded inserts

