

Small Compression Spring Panel Latches

Slotted Head

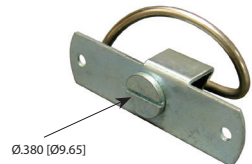

Part Number	Mounting	Base & Head Material	Spring	Finish	Grip
11-00ZN	holes	steel	smooth	blue zinc plated	.05 [1.3] min. - .25 [6.4] max.
11-02CO	weld guides	steel	smooth	copper plated	.05 [1.3] min. - .25 [6.4] max.

Knurled Head



Part Number	Mounting	Base & Head Material	Spring	Finish	Grip
11-04ZN	holes	steel	smooth	blue zinc plated	.05 [1.3] min. - .25 [6.4] max.
11-06CO	weld guides	steel	smooth	copper plated	.05 [1.3] min. - .25 [6.4] max.

Black Knob Head

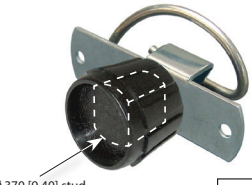

Part Number	Mounting	Base & Head Material	Spring	Finish	Grip
11-08ZN	holes	steel	smooth	blue zinc plated	.05 [1.3] min. - .25 [6.4] max.
11-09CO	weld guides	steel	smooth	copper plated	.05 [1.3] min. - .25 [6.4] max.

▶ all small compression spring latches feature 304SS electropolished wire

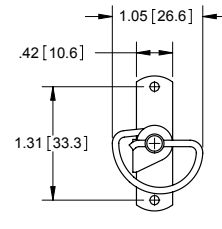
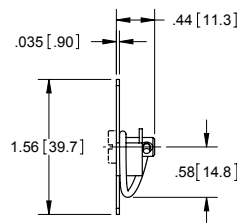
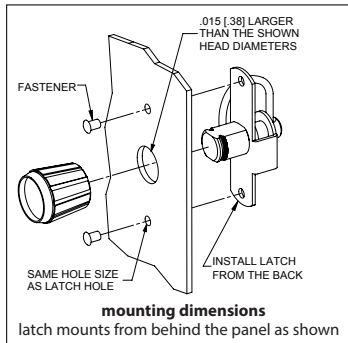

HOLES

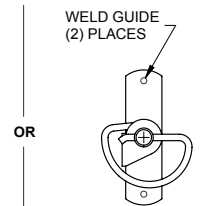

OR

WELD GUIDES

Medium Compression Spring Panel Latches

Slotted Head

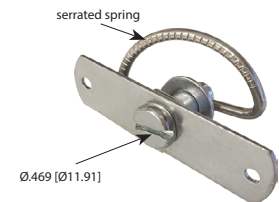

Part Number	Mounting	Base & Head Material	Spring	Finish	Grip
11-10ZN	holes	steel	smooth	blue zinc plated	.06 [1.5] min. - .38 [9.7] max.
11-10ZN50	holes	steel	serrated	blue zinc plated	.06 [1.5] min. - .38 [9.7] max.
11-10SS	holes	304SS	smooth	electropolished	.06 [1.5] min. - .38 [9.7] max.
11-15CO	weld guides	steel	smooth	copper plated	.06 [1.5] min. - .38 [9.7] max.
11-15CO50	weld guides	steel	serrated	copper plated	.06 [1.5] min. - .38 [9.7] max.
11-15SS	weld guides	304SS	smooth	electropolished	.06 [1.5] min. - .38 [9.7] max.
11-16CO	none	steel	smooth	copper plated	.06 [1.5] min. - .38 [9.7] max.
11-16SS	none	304SS	smooth	electropolished	.06 [1.5] min. - .38 [9.7] max.
11-20ZN	holes	steel	smooth	blue zinc plated	.25 [6.4] min. - .56 [14.2] max.

Knurled Head with T-Bar



Part Number	Mounting	Base & Head Material	Spring	Finish	Grip
11-30ZN	holes	steel	smooth	blue zinc plated	.06 [1.5] min. - .38 [9.7] max.
11-30ZN50	holes	steel	serrated	blue zinc plated	.06 [1.5] min. - .38 [9.7] max.

▶ all medium compression spring latches feature 304SS electropolished wire

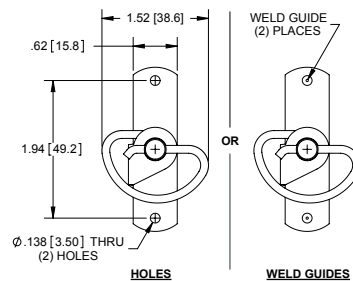
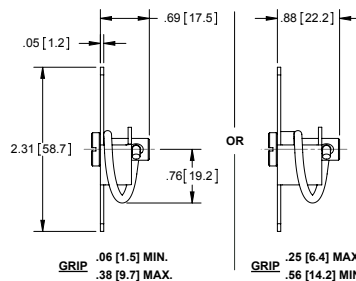

OR

WELD GUIDES