

### Large Over Center Latches

| Part Number | Material | Finish          |
|-------------|----------|-----------------|
| 215-140ZN   | steel    | zinc plated     |
| 215-140SS   | 304SS    | electropolished |
| 215-140BK   | steel    | black matte     |

- ▶ latch and keeper surfaces must be on the same plane
- ▶ see keeper options below (sold separately)

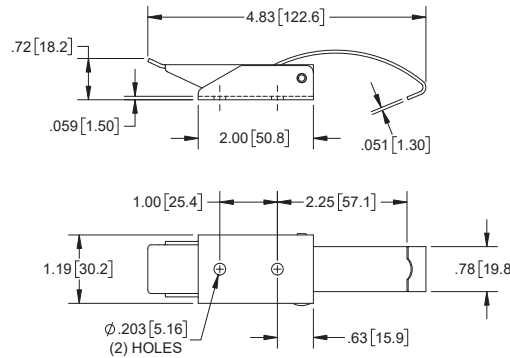

### Large Over Center Latches with Padlock Hole

| Part Number | Material | Finish          |
|-------------|----------|-----------------|
| 215-340ZN   | steel    | zinc plated     |
| 215-340SS   | 304SS    | electropolished |
| 215-340BK   | steel    | black matte     |

- ▶ latch and keeper surfaces must be on the same plane
- ▶ see keeper options below (sold separately)

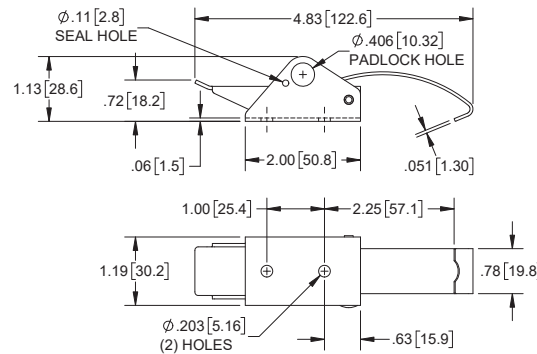

### Keepers with (1) Hole and Locator Dimple

| Part Number | Material | Finish          |
|-------------|----------|-----------------|
| 215-K21ZN   | steel    | zinc plated     |
| 215-K21SS   | 304SS    | electropolished |
| 215-K21BK   | steel    | black matte     |

- ▶ use with large latches on this pg. (sold separately)

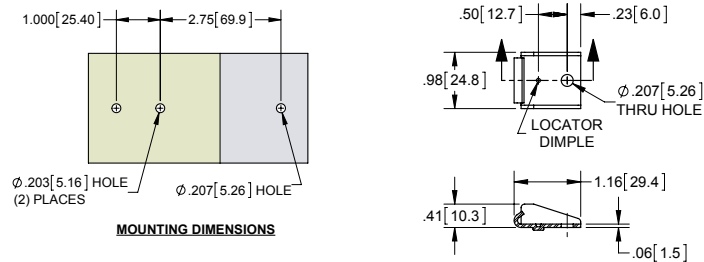

### Keepers with (2) Holes

| Part Number | Material | Finish          |
|-------------|----------|-----------------|
| 215-K24ZN   | steel    | zinc plated     |
| 215-K24SS   | 304SS    | electropolished |
| 215-K24BK   | steel    | black matte     |

- ▶ use with large latches on this pg. (sold separately)

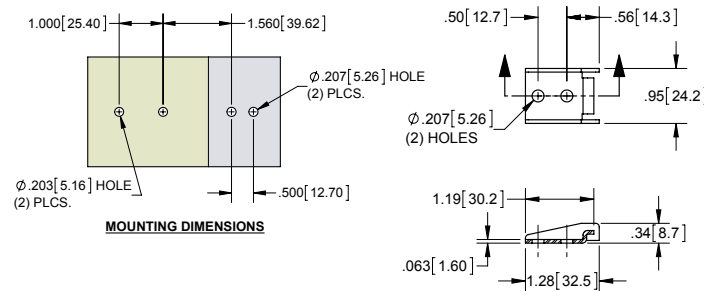

### Button Keepers

| Part Number | Material | Finish          |
|-------------|----------|-----------------|
| 215-K28ZN   | steel    | zinc plated     |
| 215-K28SS   | 304SS    | electropolished |
| 215-K28BK   | steel    | black matte     |

- ▶ use with large latches on this pg. (sold separately)

