

Mini Barrel Bolt Latches

Part Number	Material Thickness	Material	Finish
164HZ	.047 [1.19]	steel	zinc plated

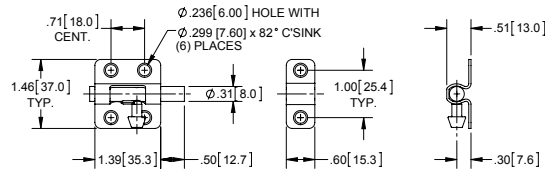

Small Standard Latch

Part Number	Material Thickness	Material	Finish
165HZ	.047 [1.19]	steel	zinc plated

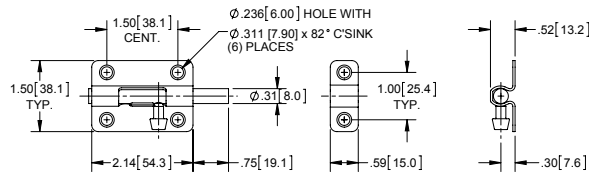

Large Standard Latch

Part Number	Material Thickness	Material	Finish
167HZ	.047 [1.19]	steel	zinc plated

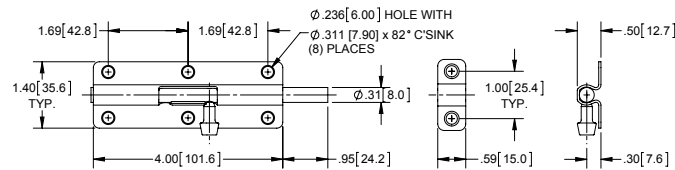

Heavy Duty Latch

Part Number	Material Thickness	Material	Finish
169HZ	.071 [1.80]	steel	zinc plated

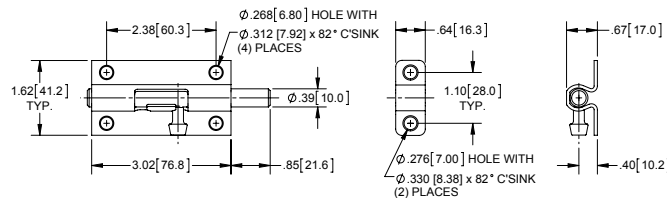

Heavy Duty Padlocking Barrel Bolt Latches

Part Number	Material	Finish
163-L	steel	zinc plated
163-K	steel	zinc plated

► latch and keeper are sold separately

