

Two Point Latch Set

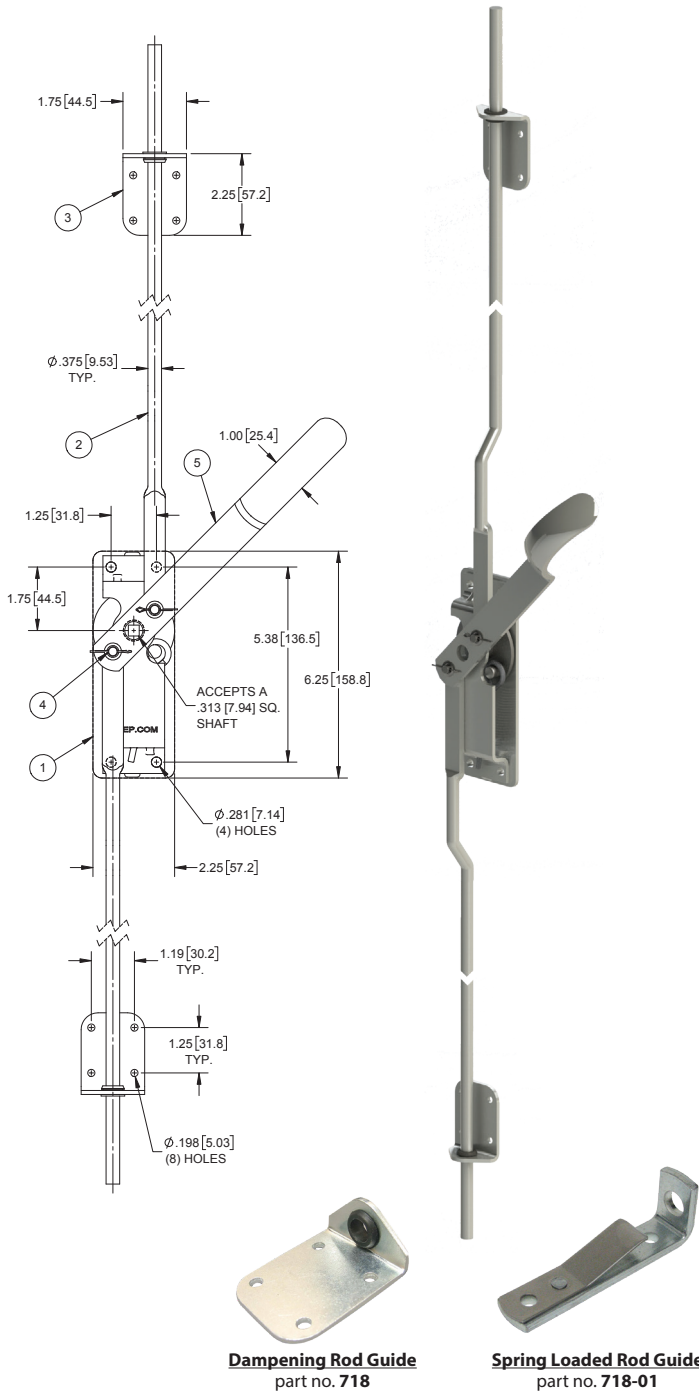

With No Inside Release Handle & Dampening Rod Guides

Part No. 716-26		
Item	Component Part No.	Description
1	716-25	(1) two point center case
2	719-48.00	(2) 48.00 [1,219.2] x Ø.38 [9.5] connecting rods
3	718	(2) rod guides with rubber damper
4	717	(2) cotter pins and (2) wave washers

- ▶ steel, zinc plated
- ▶ each part number may be ordered separately
- ▶ no override
- ▶ see handle selection on pages 40-55

With Inside Release Handle & Dampening Rod Guides

Part No. 716-27		
Item	Component Part No.	Description
1	716-25	(1) two point center case
2	719-48.00	(2) 48.00 [1,219.2] x Ø.38 [9.5] connecting rods
3	718	(2) rod guides with rubber damper
4	717	(2) cotter pins and (2) wave washers
5	736-01	(1) inside release handle

- ▶ steel, zinc plated
- ▶ each part number may be ordered separately
- ▶ no override
- ▶ see handle selection on pages 40-55

With Inside Release Handle & Spring Loaded Rod Guides

Part No. 716-28		
Item	Component Part No.	Description
1	716-25	(1) two point center case
2	719-48.00	(2) 48.00 [1,219.2] x Ø.38 [9.5] connecting rods
3	718-01	(2) spring loaded rod guides
4	717	(2) cotter pins and (2) wave washers
5	736-01	(1) inside release handle

- ▶ steel, zinc plated
- ▶ each part number may be ordered separately
- ▶ no override
- ▶ see handle selection on pages 40-55

Center Case Latch

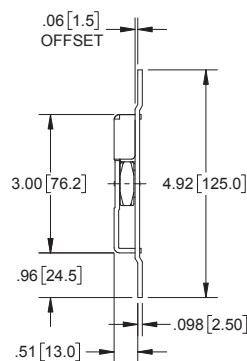
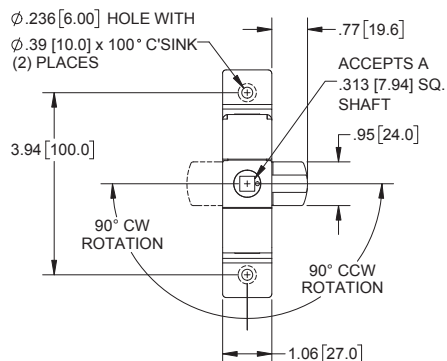

Part Number	Material	Finish
753	steel	zinc plated

- ▶ cam rotates 180°
- ▶ cam detents every 90°
- ▶ no override
- ▶ can be used as left hand or right hand