

Stock Steel Cane Bolt Latches **Saver**

Left Hand Part Number	A	B	C	D	E	F	G	H	J	Right Hand Part Number
1841HZ	1.375	none	.750	.158	.250	.040	.188	.625	.187	1941HZ
1861NN	2.00	none	.875	.187	.375	.050	none	.69	none	1961NN
1871HN	2.75	1.375	.750	.250	.500	.060	.250	.81	.250	1971HN
1871HZ	2.75	1.375	.750	.250	.500	.060	.250	.81	.250	1971HZ
1871NZ	2.75	none	.750	.250	.500	.060	none	.81	none	1971NZ
1871NN	2.75	none	.750	.250	.500	.060	none	.81	none	1971NN
1872HZ	2.75	1.375	.750	.250	.500	.060	.250	.81	.250	1972HZ
1872NN	2.75	none	.750	.250	.500	.060	none	.81	none	1972NN
1881HZ	2.75	1.375	1.00	.250	.500	.060	.250	.81	.250	1981HZ
1881NN	2.75	none	1.00	.250	.500	.060	none	.81	none	1981NN
1882HZ	2.75	1.375	1.00	.250	.500	.060	.250	.81	.250	1982HZ
1882NZ	2.75	none	1.00	.250	.500	.060	none	.81	none	1982NZ
1882NN	2.75	none	1.00	.250	.500	.060	none	.81	none	1982NN

- ▶ steel leaves
- ▶ steel, zinc plated pins
- ▶ spring steel zinc plated c-clips
- ▶ 304SS springs
- ▶ in stock

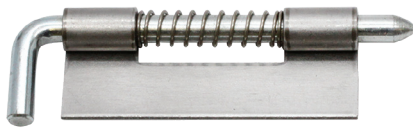

example part no. **1951NN**

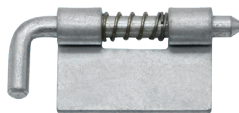

example part no. **1921NZ**

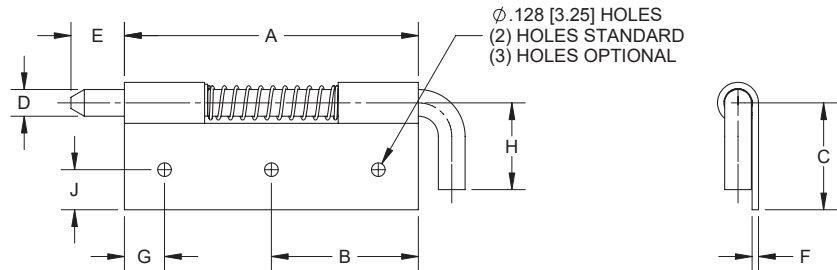

LEFT HAND SHOWN

EXAMPLE PART NO. 181 1 H Z

BASIC PART NUMBER ——— 181

PIN NOSE STYLE ——— 1

N - NO MOUNTING HOLES
H - WITH MOUNTING HOLES

N - NO FINISH ON LEAF
Z - ZINC FINISH ON LEAF

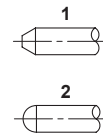

PIN NOSE STYLE

Build Your Own Cane Bolt Latches

Left Hand Part Number	A	B	C	D	E	F	G	H	J	Right Hand Part Number
181 X X X	.875	.438	.375	.125	.187	.040	.156	.437	.156	191 X X X
182 X X X	.875	.438	.500	.125	.187	.040	.156	.437	.156	192 X X X
183 X X X	1.375	.688	.500	.156	.250	.040	.187	.625	.187	193 X X X
184 X X X	1.375	.688	.750	.156	.250	.040	.187	.625	.187	194 X X X
185 X X X	2.00	1.00	.625	.187	.375	.050	.250	.687	.187	195 X X X
186 X X X	2.00	1.00	.875	.187	.375	.050	.250	.687	.187	196 X X X
187 X X X	2.75	1.375	.750	.250	.500	.060	.250	.812	.250	197 X X X
188 X X X	2.75	1.375	1.00	.250	.500	.060	.250	.812	.250	198 X X X