

### Die Cast Zinc Butt Hinge

Part Number	Mounting	Finish
<b>H2073-02</b>	1/4-20 threaded studs	black powder coated

- ▶ material: die cast zinc
- ▶ steel, nickel plated threaded studs
- ▶ steel, nickel plated pin

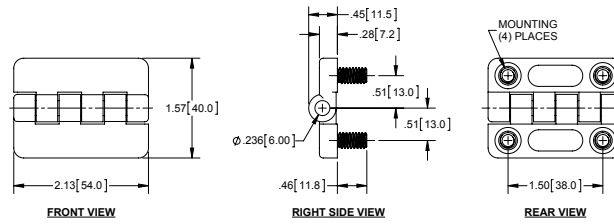

### Die Cast Zinc Butt Hinges

Part Number	Mounting	Finish
<b>H2081</b>	M6 threaded studs	black powder coated
<b>H2081CH*</b>		bright chrome plated
<b>H2081SC*</b>		satin chrome
<b>H2081-02</b>	Ø6.30mm hole with Ø11.20mm x 90° c'sink	black powder coated
<b>H2081CH-02</b>		chrome plated
<b>H2081SC-02</b>		satin chrome

- ▶ material: die cast zinc
- ▶ stainless steel threaded studs
- ▶ stainless steel pin
- ▶ \* **H2081CH** & **H2081SC** have .47 [12.0] long studs

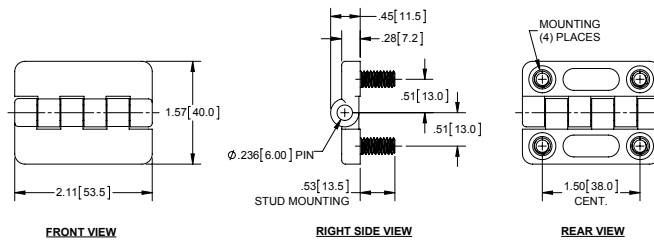

### Cast Butt Hinges

Part Number	Mounting	Finish
<b>H2080</b>	M5 threaded studs	black powder coated
<b>H2080-02</b>	Ø5.30mm hole with Ø9.30mm x 90° c'sink	black powder coated
<b>H2080SS-02*</b>	Ø5.30mm hole with Ø9.30mm x 90° c'sink	brushed

- ▶ material: die cast zinc
- ▶ \***H2080SS-02** comes in stainless steel
- ▶ stainless steel threaded studs
- ▶ stainless steel pin

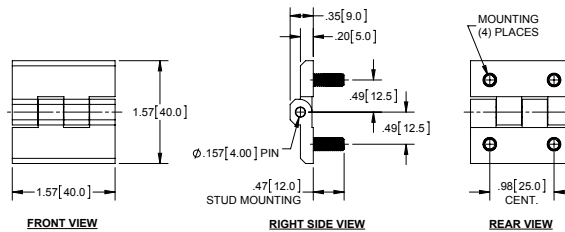

part no. H2080



part no. H2080SS-02

### Die Cast Zinc Butt Hinge

Part Number	Material	Finish
<b>H2078</b>	die cast zinc	black powder coated

- ▶ stainless steel, passivated pin

