

Enclosure Hinge

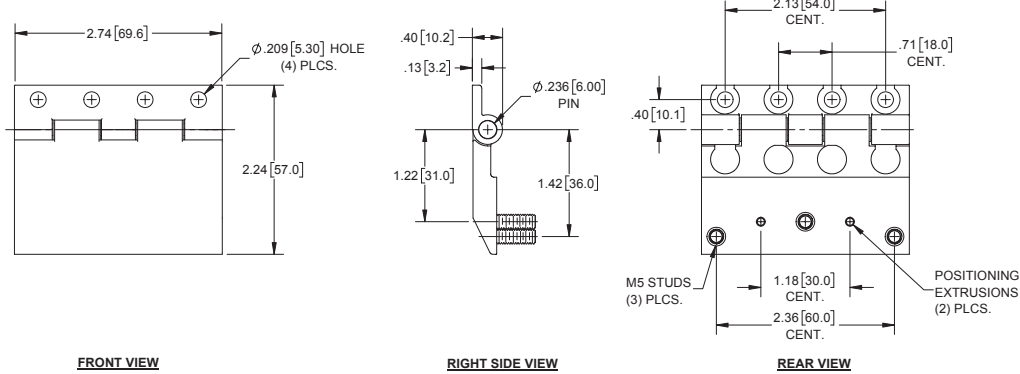

Part Number	Material	Finish
H2216	die cast zinc	smooth black powder coated

- ▶ pin: steel, nickel plated
- ▶ studs: stainless steel, black powder coated
- ▶ brass bushings
- ▶ mounting screw size M5 or #10



Cast Hinge with Offset Leaves



Part No.	Material	Finish
H2079	die cast zinc	black textured

- ▶ stainless steel pin & c-clips
- ▶ plastic bushings
- ▶ mounting screw size M5 or #10 F.H.S.

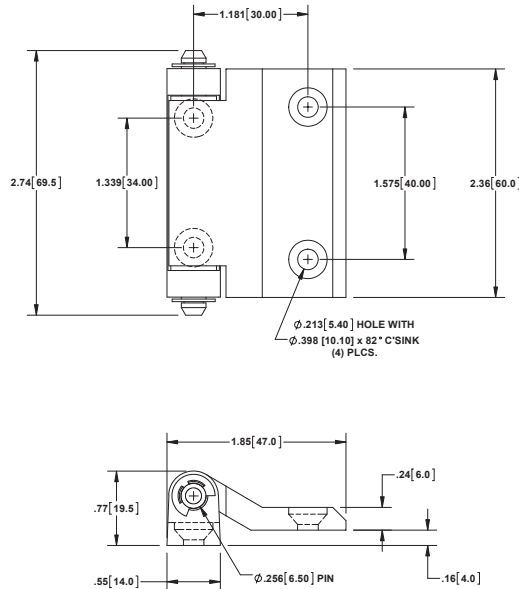

Die Cast Zinc Hinge



Part No.	Material	Finish
H2247BK	die cast zinc	matte black

- ▶ steel, zinc plated pin
- ▶ mounting screw size M6 or 1/4" F.H.S.

