

### 3.00 [76.0] Lift-off Hinge, Stainless Steel

Part No.	Material	Finish
<b>ML49SS</b>	stainless steel	mill

▶ removable 304SS pin

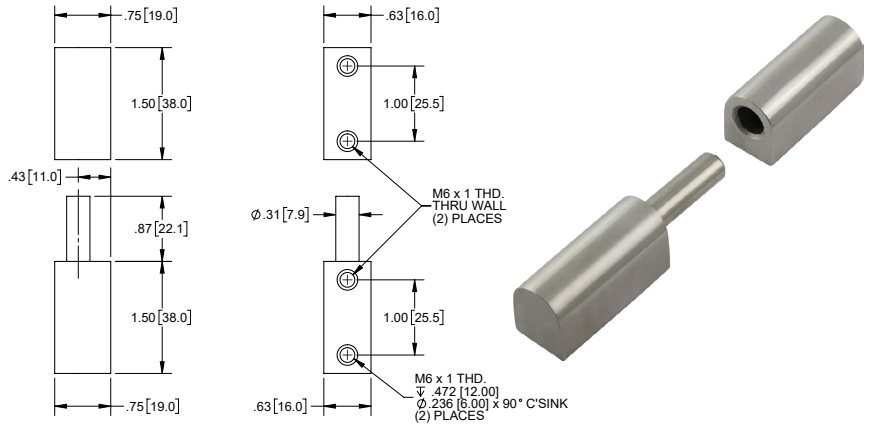

### 1.97 [50.0] Offset Lift-off Hinge, Die Cast Zinc

Part Number	Material	Finish
<b>ML19CH</b>	die cast zinc	polished chrome plated

▶ male leaf has .20 [5.0] offset  
▶ removable 304SS pin

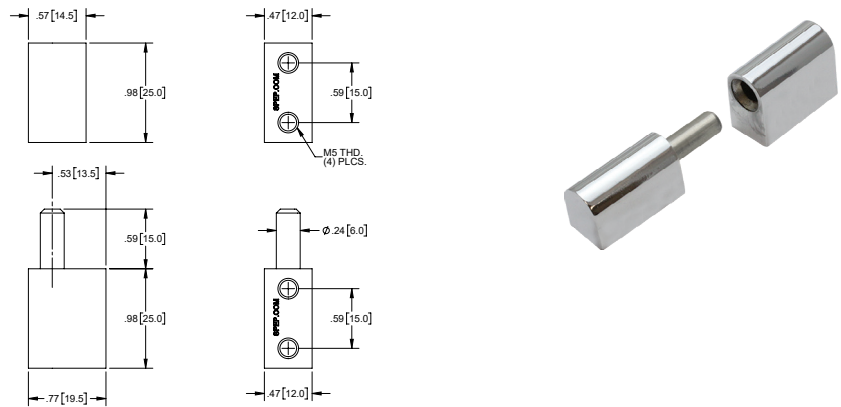

### 3.78 [96.0] Plastic Lift-off Hinge

Part Number	Material	Finish
<b>ML20P</b>	ABS	black

▶ 304SS pin

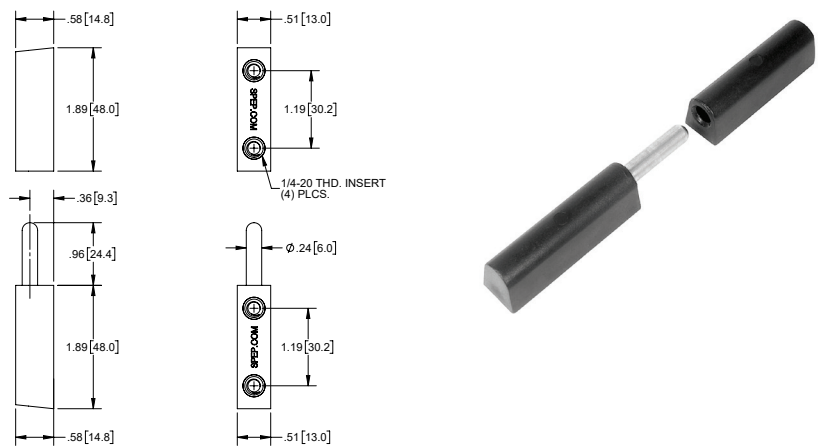

### 2.44 [62.0] Plastic Lift-off Hinges with Clip Retention

Part Number	Description	Material	Finish
<b>ML22P-05</b>	left hand	glass reinforced nylon	black
<b>ML23P-05</b>	right hand	glass reinforced nylon	black

▶ nylon pin  
▶ includes plastic clip & rubber insert for pin retention to female leaf

