

Safety Hasp & Staple (Steel)

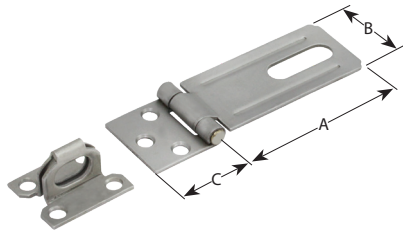

Part Number	Finish	Material Thickness	A	B	C	Screw Size
2803	zinc plated	.080 [2.03]	3.30 [83.8]	1.50 [38.1]	1.31 [33.3]	#6
2803PL	mill	.080 [2.03]	3.30 [83.8]	1.50 [38.1]	1.31 [33.3]	#6
2804	zinc plated	.080 [2.03]	4.43 [112.5]	1.50 [38.1]	1.97 [50.0]	#7
2804PL	mill	.080 [2.03]	4.43 [112.5]	1.50 [38.1]	1.97 [50.0]	#7
2806	zinc plated	.080 [2.03]	6.00 [152.4]	1.75 [44.5]	2.71 [68.8]	#8
2806PL	mill	.080 [2.03]	6.00 [152.4]	1.75 [44.5]	2.71 [68.8]	#8

Safety Hasp & Staple (Steel)

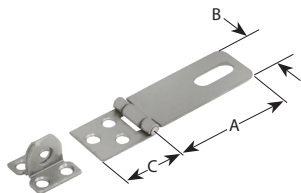

Part Number	Finish	Material Thickness	A	B	C	Screw Size
2812	zinc plated	.067 [1.70]	2.50 [63.5]	1.00 [25.4]	1.125 [28.58]	#5
2812PL	mill	.067 [1.70]	2.50 [63.5]	1.00 [25.4]	1.125 [28.58]	#5

Swivel Safety Hasp & Staple (Steel)

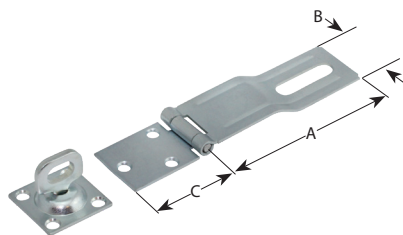

Part Number	Finish	Material Thickness	A	B	C	Screw Size	Staple Part No.
2833	zinc plated	.075 [1.91]	3.25 [82.6]	1.50 [38.1]	1.28 [32.5]	#7	2835
2834	zinc plated	.075 [1.91]	4.34 [110.2]	1.50 [38.1]	1.94 [49.3]	#7	
2836	zinc plated	.079 [2.00]	6.00 [152.4]	1.75 [44.5]	2.75 [69.9]	#8	

Large Safety Hasp & Staple (Steel)

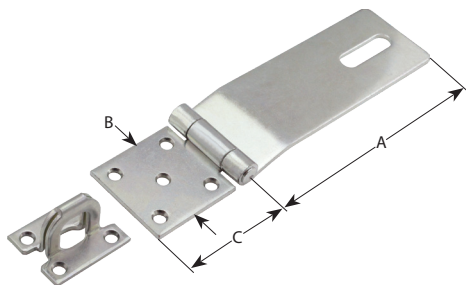

Part Number	Finish	Material Thickness	A	B	C	Screw Size
2817	zinc plated	.157 [4.00]	7.00 [177.8]	2.50 [63.5]	2.75 [69.9]	#10

▶ this part is non-stock

Light Duty Hasp & Staple (Steel)

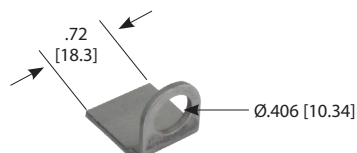
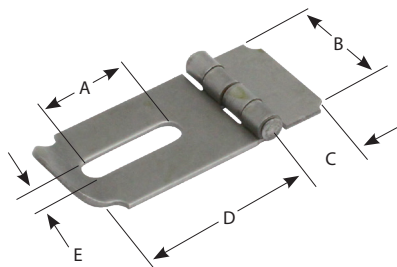

Hasp

Part Number	Material Thickness	A	B	C	D	E	Finish
2884	.060 [1.52]	1.00 [25.4]	1.13 [28.7]	.63 [16.0]	1.86 [47.2]	.250 [6.35]	mill

Staple

Part Number	Material Thickness	Finish
2883	.079 [2.00]	mill